

## SUITE INFORMATION

PROJECT ADDRESS: 3925 WASHINGTON RD  
MCMURRAY, PA 15317

COUNTY: WASHINGTON COUNTY

LEASABLE SF: 3608 SF \*BOMA STANDARD

STORIES: 1 STORY

FIRE PROTECTION: SPRINKLERED

**\*NOTE:**

EXISTING CONDITIONS HAVE BEEN CAPTURED AND DOCUMENTED VIA MATTERPORT PRO (2 OR 3) CAMERA. SEE TABLE BELOW FOR CAMERA ACCURACY. CONTRACTOR TO VERIFY ALL DIMENSIONS IN FIELD.

CAMERA ACCURACY SPECS PROVIDED BY MATTERPORT, INC.

CAMERA	5m	10m
MATTERPORT PRO 2	±54mm (1%)	N/A
MATTERPORT PRO 3	N/A	±20mm (0.2%)



## EXIST FIRST FLOOR-LEASE PLAN NTS

**ZAMAGIAS**  
PROPERTIES

DONALDSON'S CROSSROADS

3925 WASHINGTON RD  
MCMURRAY, PA 15317  
12/31/25

**WILDMAN  
CHALMERS**  
DESIGN

WWW.WILDMANCHALMERS.COM  
1622 LOWRIE ST PITTSBURGH PA 15212  
PHONE 412.436.9303

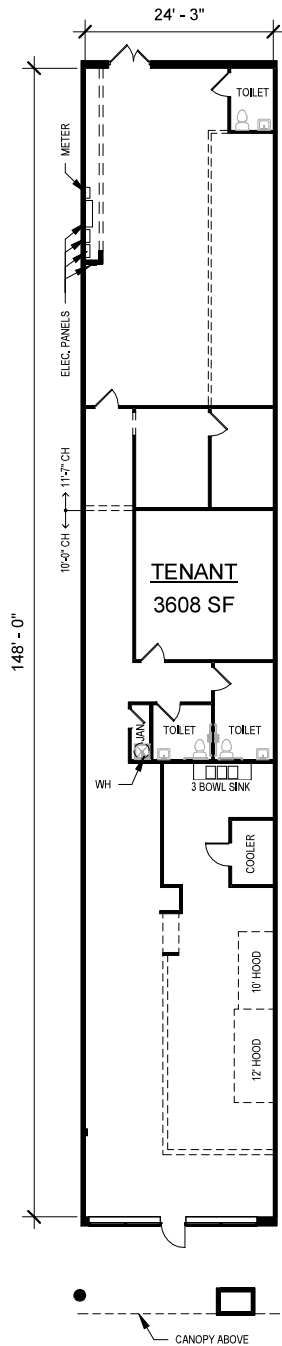

## SUITE INFORMATION

PROJECT ADDRESS: 3925 WASHINGTON RD  
MCMURRAY, PA 15317

COUNTY: WASHINGTON COUNTY

LEASABLE SF: 3608 SF \*BOMA STANDARD

STORIES: 1 STORY

FIRE PROTECTION: SPRINKLERED

**\*NOTE:**

EXISTING CONDITIONS HAVE BEEN CAPTURED AND DOCUMENTED VIA MATTERPORT PRO (2 OR 3) CAMERA. SEE TABLE BELOW FOR CAMERA ACCURACY. CONTRACTOR TO VERIFY ALL DIMENSIONS IN FIELD.

CAMERA ACCURACY SPECS PROVIDED BY MATTERPORT, INC.

CAMERA	5m	10m
MATTERPORT PRO 2	±54mm (1%)	N/A
MATTERPORT PRO 3	N/A	±20mm (0.2%)



## EXIST FIRST FLOOR-LEASE PLAN NTS

**ZAMAGIAS**  
PROPERTIES

DONALDSON'S CROSSROADS

3925 WASHINGTON RD  
MCMURRAY, PA 15317  
12/31/25

**WILDMAN  
CHALMERS**  
DESIGN

WWW.WILDMANCHALMERS.COM  
1622 LOWRIE ST PITTSBURGH PA 15212  
PHONE 412.436.9303